

COMPETITION

CATALOGUE

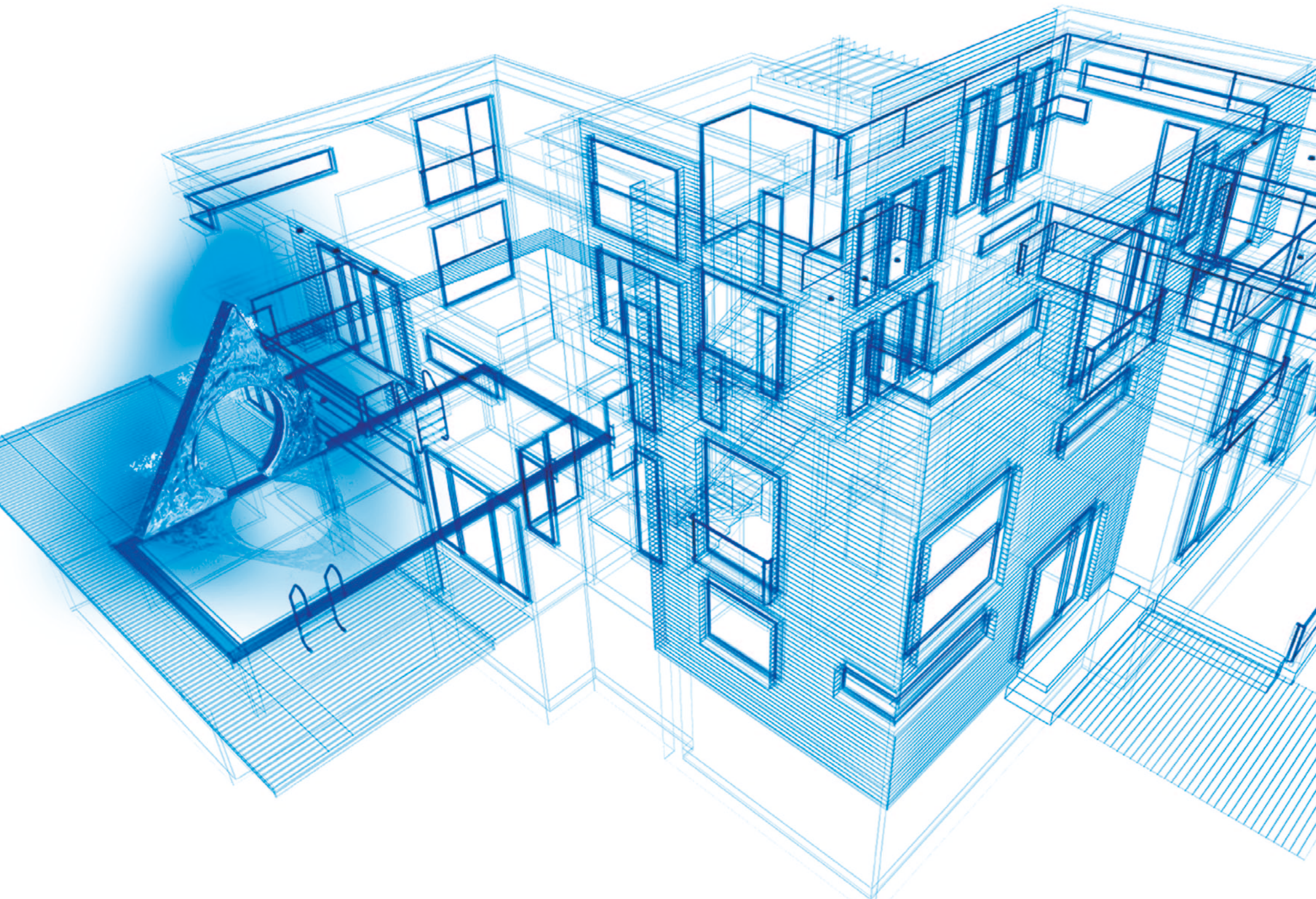

The swimming pool brand

Our products can be found in over **170 countries**. We have over **40 years** of experience. Over **40,000 professionals** and **2,000,000 swimming pools** use one of our **15,000 products**. Completely innovative and sustainable solutions. For all of these reasons and many more, our systems and components for public and private pools are and will continue to be world leaders.

We set the benchmark for professionals and private home owners. Let AstralPool surprise you once again.

And remember: when you see our brand, you're looking at **the pool brand**.



Infinite, unique experiences...



Pools for sharing emotions



Eco-friendly pools for staying green



Pools for relaxing



Pools for keeping fit



... for infinite, unique people



INDEX

COMPETITION PRODUCTS



STARTING BLOCKS
LANE ROPES
FLOATS
LANE ROPE STORAGE
LANE ROPE ACCESSORIES
SIGNAGE
TURNING PANELS
SPARGER

OUTDOOR PRODUCTS



DISABLED ACCESS
LIFEGUARD ACCESSORIES
LIFEGUARD SEATS

CLEANING



AUTOMATIC POOL CLEANERS

COMPETITION POOLS

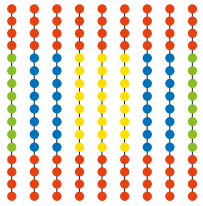

Colours according to FINA rules

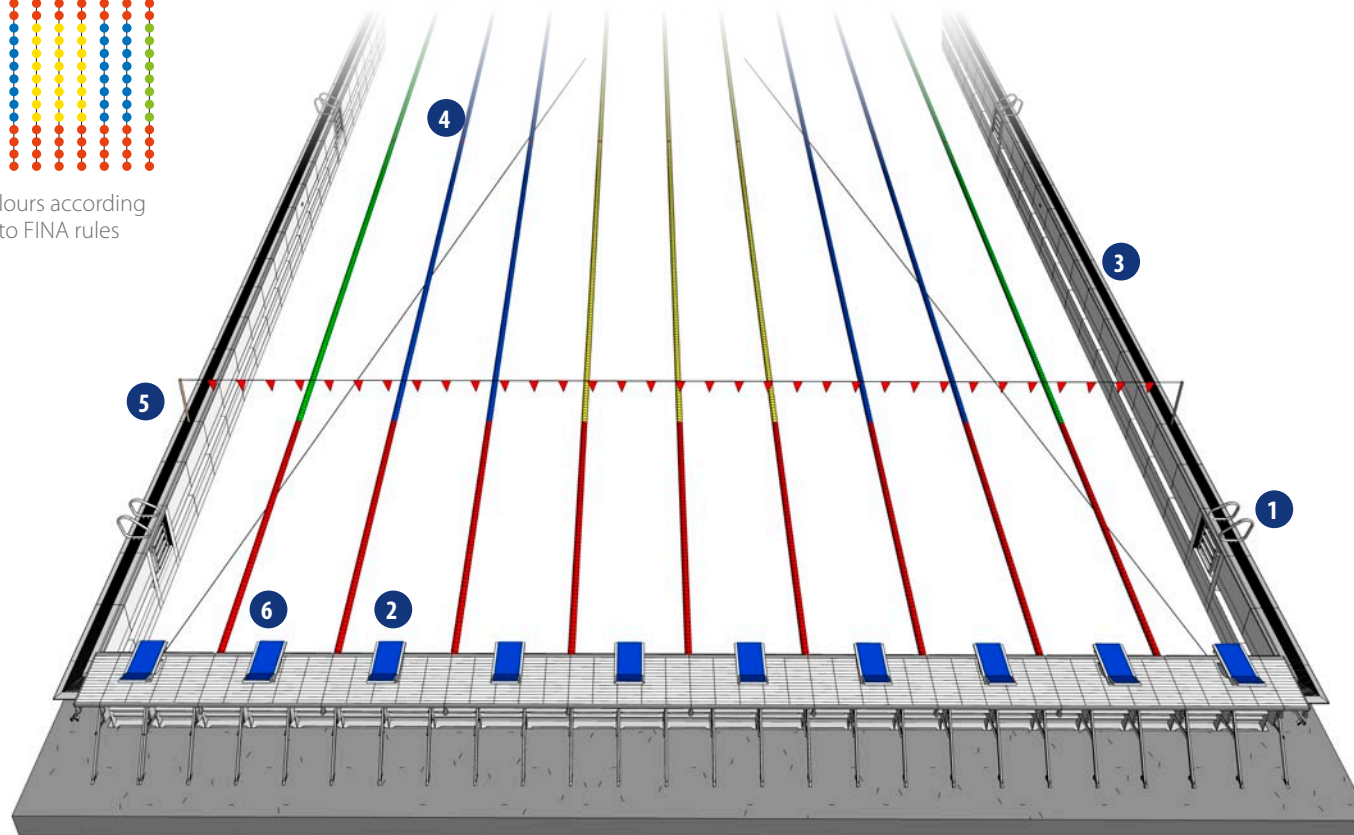

- ① Ladder
- ② Starting block
- ③ Overflow grate

- ④ Lane ropes
- ⑤ Backstroke flags
- ⑥ Turning panel with supports

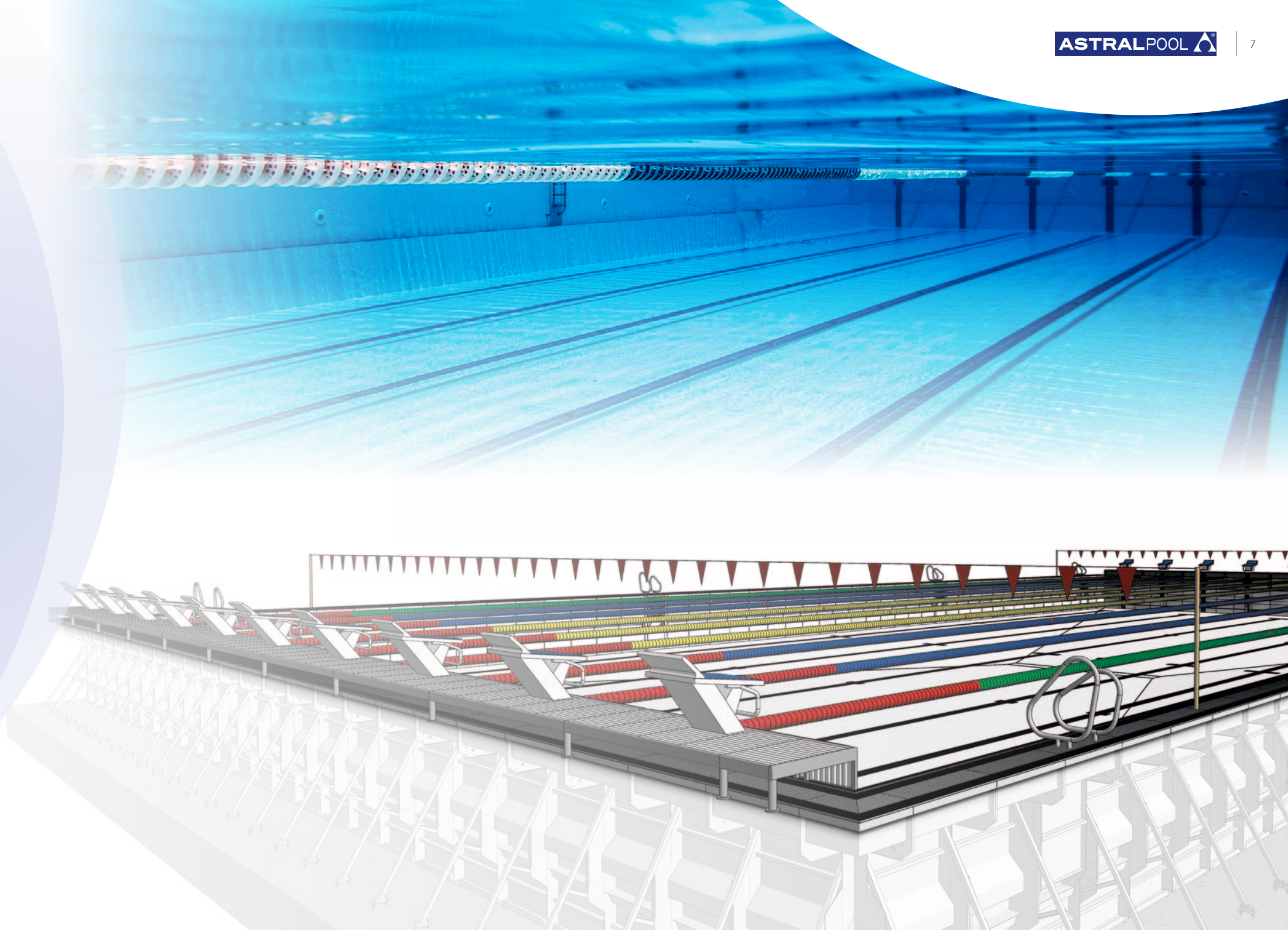

RACE PRODUCTS



STARTING BLOCKS

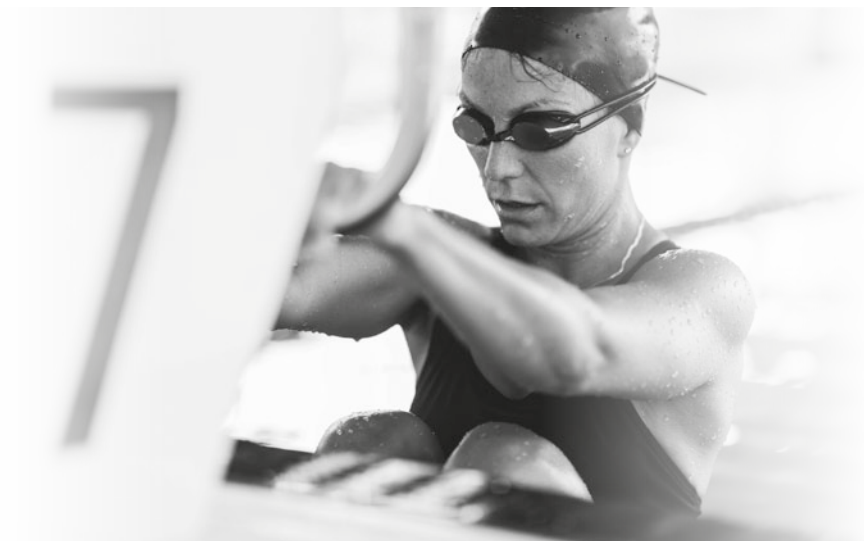

BCN STARTING BLOCK

Specially designed for competition events, it has an adjustable footrest to facilitate entry into the water. The minimalist, high quality design of the materials gives it a modern, elegant look.

Made of AISI-316 stainless steel. Polished finish.
Adjustable footrest (6 positions).
Plate anchoring (code 54460) not included.

Code **53875**

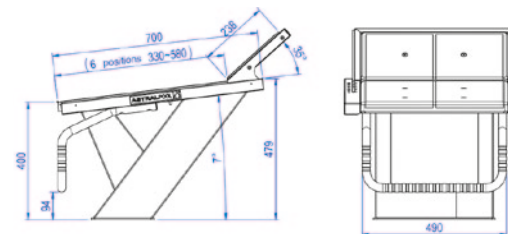



STARTING BLOCKS

Made of AISI-316 stainless steel. Adjustable polyester and fibreglass non-slip platform measuring 500 mm x 500 mm. Starting block numbers not included. Plate anchoring (code 54461) not included.

Polished finish. Height 700 mm.
 Polished finish. Height 400 mm.
 Painted white. Height 400mm.

Code **00144**
 Code **00145**
 Code **19957**

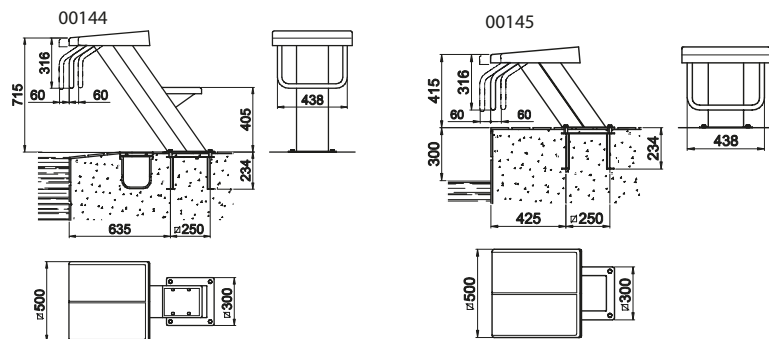

STARTING BLOCKS

Made of AISI-304 stainless steel. Adjustable polyester and fibreglass non-slip platform measuring 500 mm x 500 mm. Starting block numbers not included. Plate anchoring not included.

Polished finish. Height 700 mm.
 Polished finish. Height 400 mm.
 Painted white. Height 700mm.
 Painted white. Height 400mm.

Code **00146***
 Code **27578**
 Code **19958**
 Code **27836**

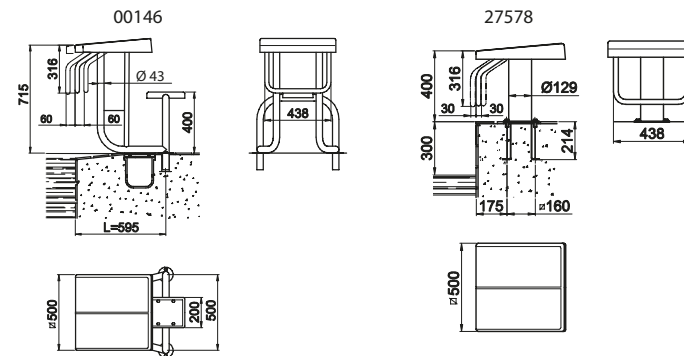

* The starting block with code 00146 may be made to measure to adapt to the position of the overflow outlets.



STARTING BLOCK PLATFORM

AstralPool has created a platform on which the starting blocks can be attached. This product is made up of an AISI-304 stainless steel structure and plastic grating. The platform can also be used as a turning panel and has fastening points for the lane ropes.

Block platform, lane width 2 m
 Block platform, lane width 2.5 m
 Block platform, far right
 Block platform, far left

Code **34213**
 Code **34214**
 Code **34215**
 Code **34216**

STARTING BLOCK FASTENERS

Starting block fasteners to be embedded into concrete, made of AISI-304/316 stainless steel, comprising a base that can be embedded, screws and washers, with electrical bonding.

Starting block (Code 53875) fastener in AISI-316
 Starting block (Code 00144 - 00145 - 19957) fastener in AISI-316
 Starting block (Code 27578 - 27836) fastener in AISI-304
 Starting block (Code 00146 - 19958) fastener in AISI-304

Code **54460**
 Code **54461**
 Code **54462**
 Code **00143**



STARTING BLOCK NUMBERS

4 units included.

Height 80 mm (For starting blocks 00146-27578-19958-27836)

For starting block numbers 1 to 6 Code **28616**
 For starting block numbers 1 to 10 Code **28617**

Height 100 mm (For starting blocks 00144-00145-19956-19957-28760-28761)

For BCN03 starting blocks 1 to 6 Code **34200**
 For BCN03 starting blocks 1 to 10 Code **34201**



LANE ROPES

COMPETITION LANE ROPES

These are supplied assembled with floats, 6 mm stainless steel cable (28808), tensor (00208), shock absorber (01468) and hook (00207). Floats with inner turbine mechanism, with outer Ø of 148 mm in keeping with International Swimming Federation regulations (FINA).



BCN03 MODEL

25 m



Code
67599
67601
67602
67603

50 m



67600
67604
67605
67606



SYDNEY MODEL

12,5 m



Code
67607

16,5 m



67608

25 m



67609
67612
67613
67614

33 m

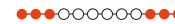

67610

50 m



67611
67615
67616
67617

LEISURE LANE LINES*

These are supplied assembled with floats, polyester rope of 7 mm (00210), tensor (00209) and hook (00207).



ROMA MODEL

Floats with outer Ø of 68 mm.

12,5 m



Code
67618

16,5 m



67619

25 m



67620

33 m

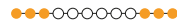

67621

50 m

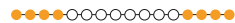

67622



MOSCOW MODEL

Floats with inner turbines, with outer Ø of 105 mm.

12,5 m



Code
67623

16,5 m



67624

25 m



67625

33 m

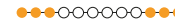

67626

50 m

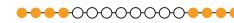

67627



 FLOATS



MODEL BCN03

- | | |
|------|-------|
| Code | |
| ○○○○ | 28204 |
| ●●●● | 28425 |
| ●●●● | 28423 |
| ●●●● | 28424 |
| ●●●● | 34584 |



SYDNEY MODEL

- | | |
|------|-------|
| Code | |
| ○○○○ | 54032 |
| ●●●● | 54030 |
| ●●●● | 54028 |
| ●●●● | 54029 |
| ●●●● | 54031 |

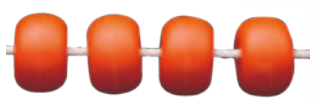

ROMA MODEL

- | | |
|------|-------|
| Code | |
| ○○○○ | 00149 |
| ●●●● | 00150 |
| ●●●● | 00151 |
| ●●●● | 00152 |
| ●●●● | 43177 |

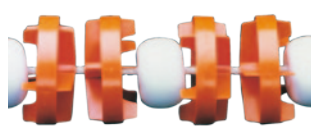

MOSCOW MODEL

- | | |
|------|-----------|
| Code | |
| ○○○○ | 00161 |
| ●●●● | 00162 |
| ●●●● | 00163 |
| ●●●● | 00164 |
| ●●●● | 00163VV99 |



LANE ROPE STORAGE



**BCN03 LANE ROPE
STORAGE TROLLEY**

Code **28623**



**STOWABLE
STORAGE REEL**

Code **15842**



**PORTABLE LANE
ROPE ROLLER**

Width 1.2 m Code **58860**
Width 1.8 m Code **58859**



LANE ROPE ACCESSORIES



LANE ROPE TENSOR

Code **00208**



TENSOR

Code **00209**



LANE ROPE SHOCK ABSORBER

Code **01468**



LANE ROPE HOOK

Code **00207**



LANE ROPES AND CABLES

In polyester Ø 7 mm
Code **00210**

In Ø 6 mm stainless steel with no coating

Code **28808**



SIGNAGE

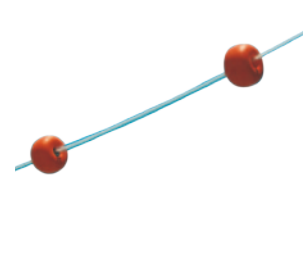

FALSE START SIGNAGE

False start posts:

For pool width of up to 21 m, Ø 43 mm tube (for coupling with anchors 00141 & 00142).

Code **19950**

For pool width of up to 21 m, tube Ø 48 mm (for coupling with anchors 19960 & 19961). Code **19951**

False start float line:

Polyester rope and floats.

Code **19954**



BACKSTROKE TURN INDICATORS

Backstroke turn indicator posts

For pool width of up to 21 m, Ø 43 mm tube (for coupling with anchors 00141 & 00142).

Code **19952**

For pool width of up to 21 m, Ø 48 mm tube (for coupling with anchors 19960 & 19961). Code **19953**

Backstroke flags:

Set of 2 units.

Code **19955**



ANCHORING

ANCHORING FOR COMPETITION EQUIPMENT

Horizontal flange anchoring sockets Zurich-Wiesbaden AISI-316

For Ø 43 mm.

Code **00141**

For Ø 48 mm.

Code **19960**

Angled flange anchoring socket Finnish AISI-316

For Ø 43 mm.

Code **00142**

For Ø 48 mm.

Code **19961**

Anchoring socket with locking bolts with bolts AISI-316

For Ø 43 mm.

Code **00143**



TURNING PANELS



TURNING PANEL

In AISI-316 stainless steel with plastic lattice screen. Height 300 mm. Support (00139) is not included.

Lane width 2 m Code **00137**
Lane width 2.5 m Code **00138**

HOLDER

AISI stainless steel (for coupling to 00141 and 00142 fasteners). State H and L dimensions, and the type of overflow channel when you place an order. Two units are required for each rotating panel.

Code **00139**

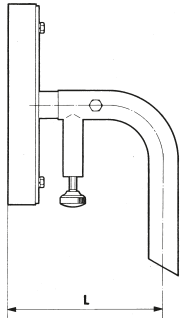

Specifications of the support when the "L" dimension is lower than 500 mm.

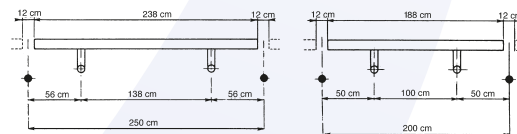

Specifications of the support when the "L" dimension is greater than 500 mm.

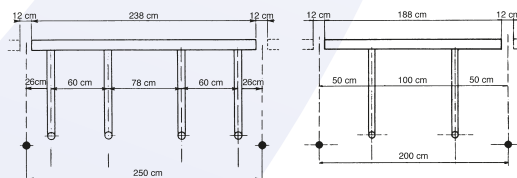

SPARGER



SPARGER – SAFETY SYSTEM FOR DIVING POOLS

This system is designed to minimise the risk of injury for divers from boards when they hit the water. The diffusers fitted at the bottom of the pool release highly pressurised air which mixes with the water to cushion divers.

Air compressor
Code **65463**

User control: Manual
Code **65477-65486**

Control unit
Code **65467-65486**

User control: Automatic
Code **65467-65477**

Diffuser boxes
Length 5.5 m Code **65464**
Length 3.0 m Code **65465**
Length 1.5 m Code **65466**

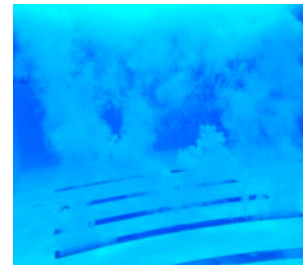

MOVABLE WALL

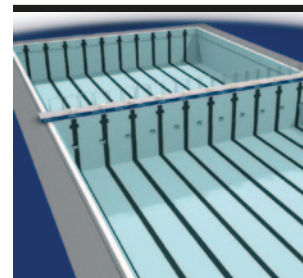

Technology for installing movable walls in pools, enabling a pool to be divided into two different parts for different uses. Thus, the best use is made of the space while variety is ensured for the users at a lower cost than that of changing the entire facility. The movable wall system can be adapted and used in pools that have already been built or in new ones.

Made of AISI-304 stainless steel lined with white, non-slip plastic plates.

POOLSIDE EQUIPMENT



DISABLED ACCESS



PORTABLE LIFT FOR DISABLED PEOPLE

Portable chair for disabled people. Requires no assembly on the poolside. This is the ideal solution for facilities with several pools, since it can be placed anywhere on the poolside and stored when not needed.

Code **49901**



PORTABLE SPLASH LIFT FOR DISABLED PEOPLE

Semi-portable chair to be installed on the poolside for disabled people. Trolley for moving the chair included to help install it in different places. Duration of 30 cycles once charged. Waterproof remote control.

SPLASH chair
Code **53924**



HYDRAULIC LIFT WITH PLATFORM

To help disabled people or those with limited mobility who need to get in and out of the water.

Made of an AISI-316 stainless steel structure in which the hydraulic mechanism that holds the platform is adapted.

L-650 lift Code 63157	L-1000 lift Code 63158	Platform Code 63159
---------------------------------	----------------------------------	-------------------------------



HYDRAULIC LIFT

Made of a tubular structure of Ø 43 mm in shiny, polished AISI-316 stainless steel adapted to the hydraulic mechanism that holds the chair, with steps on the side for the monitor.

L-650 Handrail
Code **28619**

L-1000 Handrail
Code **28620**

Cylinder
Code **28621**

Accessories
Code **28622**



500 MM WIDE LADDER

Tubular polished AISI-316 stainless steel of Ø 43 mm. Plastic steps with non-slip surface.

Supplied with fastener ready for electrical bonding.

4 steps Code 00116	5 steps Code 00117	6 steps Code 00118	7 steps Code 00119	8 steps Code 00120
------------------------------	------------------------------	------------------------------	------------------------------	------------------------------

970 MM WIDE LADDER

4 steps Code 00116 + 4 Kit 28615	5 steps Code 00117 + 5 Kit 28615	6 steps Code 00118 + 6 Kit 28615	7 steps Code 00119 + 7 Kit 28615	8 steps Code 00120 + 8 Kit 28615
--	--	--	--	--



STEP KIT FOR CONVERTING A LADDER'S WIDTH FROM 500 TO 970 MM

To turn the 500 mm ladder into 970 mm. A "Step Kit" is needed for each of the steps on the ladder. In AISI-316 polished stainless steel. Plastic steps with non-slip surface.

Code **28615**



RAISED CHAIR

Made of Ø 43 mm tubular AISI-304 stainless steel. Plastic steps, platform and chair. Wheels at base.

Lifeguard's chair
Code **56993**

Life float holder
Code **56994**

Parasol holder
Code **56995**



LIFEGUARD CHAIRS



H-400 FAST ACCESS CHAIR

Made of Ø 43 mm tubular AISI-304 stainless steel. Plastic steps, platform and chair. Large platform and chair with 90° spin to improve the field of view. Recommended for paddling and children's pools. Includes parasol holder.

Code **15673**



MULTI-PURPOSE H-1000 CHAIR

Code **15674**



LIFEGUARD ACCESSORIES



LIFE FLOAT HANGER

Code **01368**



LIFE FLOAT HOLDER

Code **01370**



LIFE FLOAT

Code **01369**



LIFE FLOAT HOLDER STAND

Code **01371**



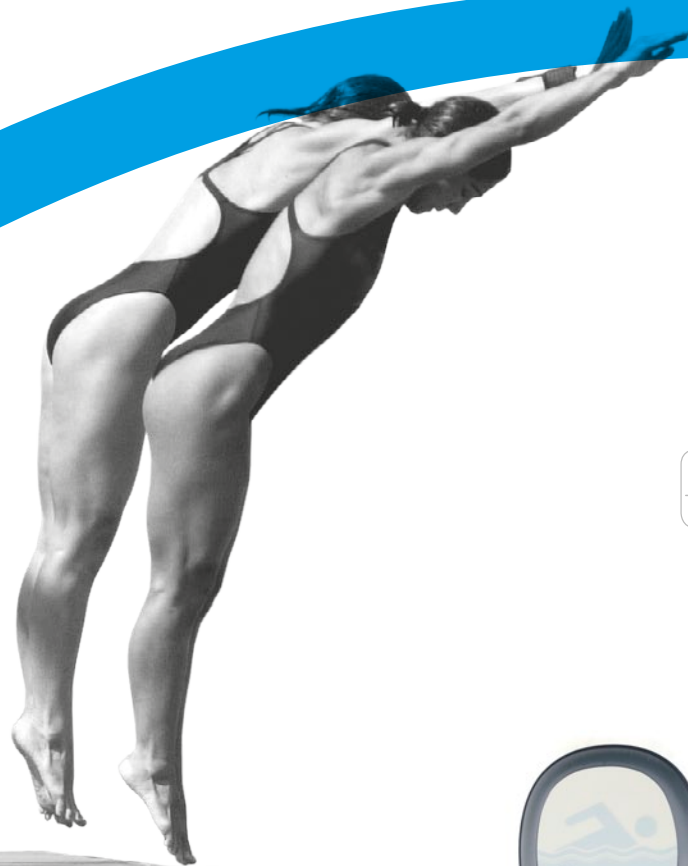

CLEANING PRODUCTS



AUTOMATIC POOL CLEANERS

ULTRA 500

Its built-in gyroscope ensures the whole of the pool floor is cleaned. It has three programs: 3, 4 or 5 h (floor only), 4 h (floor and walls) and 5 h (floor and walls). The program start can be delayed and the level of cleaning chosen. Includes remote control, 30 m of cable and caddy for moving it around, plus a LED indicator to show when the filter must be cleaned. The pump motor has a suction rate of 22 m³/h.

Code **60169**





ULTRA 125

Code **60165**



ULTRAMAX GYRO

Cable 36 m.
Cable 45 m.

Code **60164**
Code **62268**



ULTRA 250

Code **60140**



CADDY FOR AUTOMATIC POOL CLEANER

Code **04648**

Model	ULTRA 125	ULTRA 250	ULTRA 500	ULTRAMAX GYRO
Max. pool length (m)	15	25	25	50
Wall cleaning	YES	YES	YES	NO
Water line cleaning	YES	YES	NO	NO
Filter bags	1	1	1	2
Length of cable (m)	23	30	30	36/45
Caddy	NO	YES	YES	YES
Automatic programs	1 programa (3h)	3 programas (3/4/5 h), modo de limpieza extra	3 programas (3/4/5 h), modo de limpieza extra	3 programas (3/4/6 h), modo de limpieza extra
Remote control	NO	YES	YES	YES
Infrared sensor	NO	NO	NO	YES
Full filter indicator	NO	YES	YES	YES
Digital control panel	NO	NO	NO	YES
Delayed start	NO	YES	YES	YES
Warranty	2	2	2	2



www.astralpool.com



FLUIDRA



www.astralpool.com